

# INSTRUCTIONS

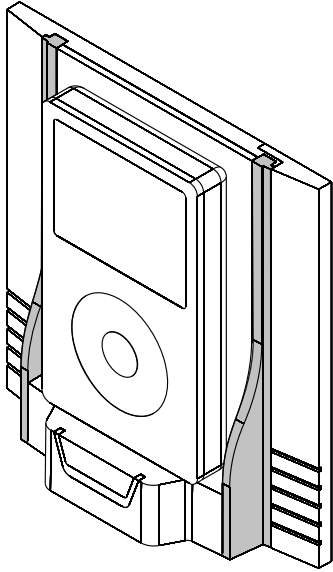

## **A0315** **iBus Wall-Dock for CAT5 Audio Systems**



iBus™  
By CHANNEL VISION™

©2010 CHANNEL VISION TECHNOLOGY

The **A0315** is an on-wall iPod® docking station for CAT5 audio systems. The dock connector slides in and out to adjust for any iPod and the non-skid pad helps to hold the music player in place. With all the popular features of A0313, the new A0315 adds elegant and contemporary styling to make it the perfect choice for anyone who wants to enjoy their music without defacing their wall. (See Made For section on page 3 for a list of compatible iPods.)

**Features:**

- Compatible with all Channel Vision CAT5 audio systems
- Charges the iPod
- Senses audio to automatically override the main audio source
- Supports IR control: compatible with A0505 or Apple Remote
- Uses CAT5 cabling
- Mounts in a standard 2-gang box

**Wall Dock**

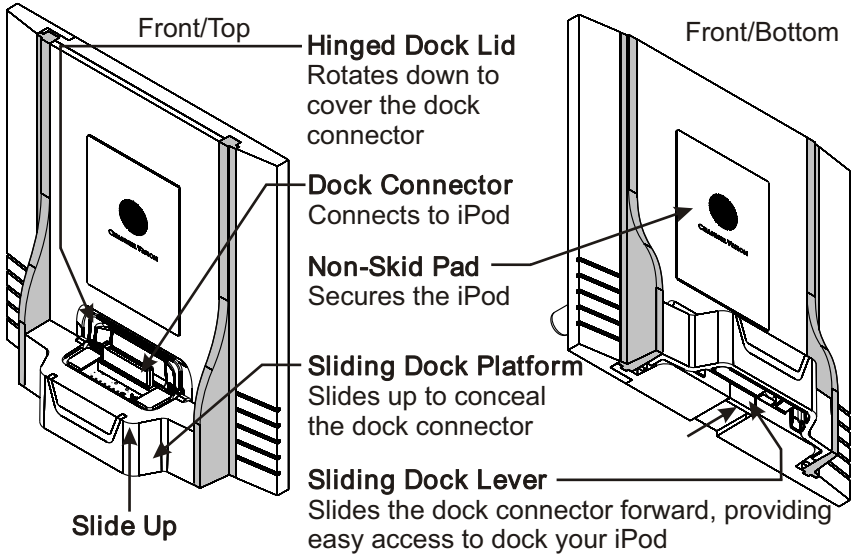

**Input RJ-45 & 110 Connectors**  
 Connect to CAT5 Audio Hub  
 CAT5 cable (only use one)

**Output RJ-45 & 110 Connectors**  
 Connect to CAT5 Audio Amplifier Input  
 CAT5 cable (only use one)

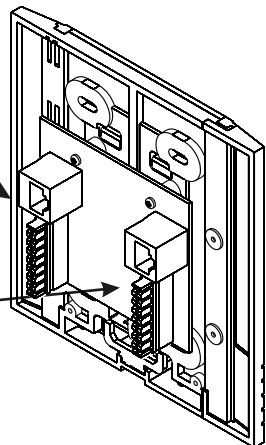

## Installing the Trim Plate Accessory

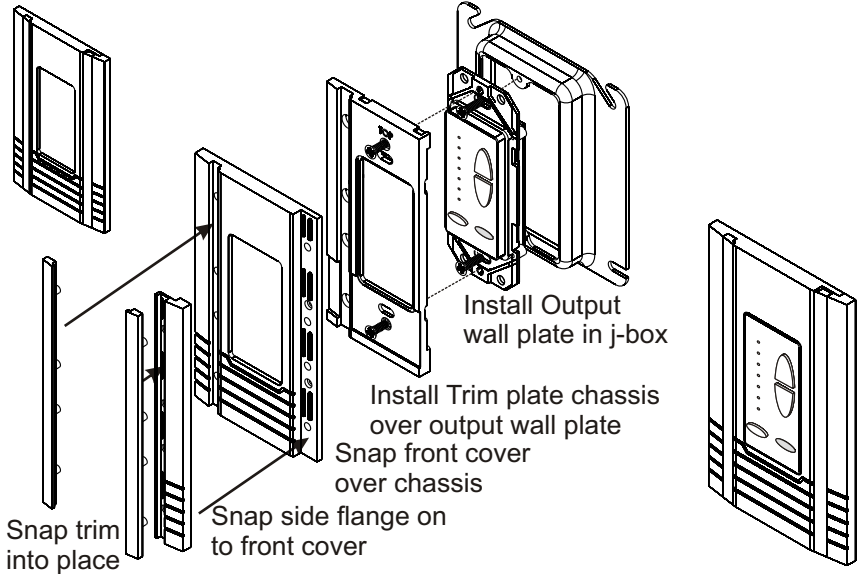

## Other Required Components

The A0313 is not a standalone device. It must be installed as part of an audio system which requires the following components:

### CAT5 Audio Hub or CAT5 Audio Matrix:

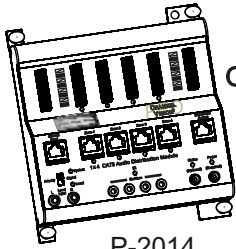

P-2014  
(power supply included)

OR

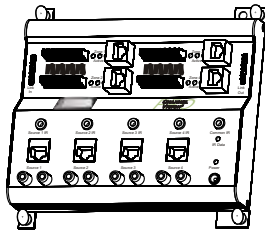

P-2044  
(power supply included)

Volume Control Keypad: A0125



Wiring Interface: A0302



In-Room Amplifier: A0240

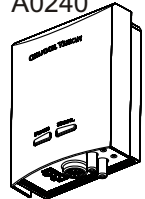

## Compatibility

### Made For:

- ◊ iPod touch (2nd generation) (4th generation)
- ◊ iPod touch (1st generation) (3rd generation)
- ◊ iPod classic
- ◊ iPod video
- ◊ iPod nano (5th generation) (iPod mini)
- ◊ iPod with dock connector

# System Wiring Diagram

Using the A0315 as a local source input module

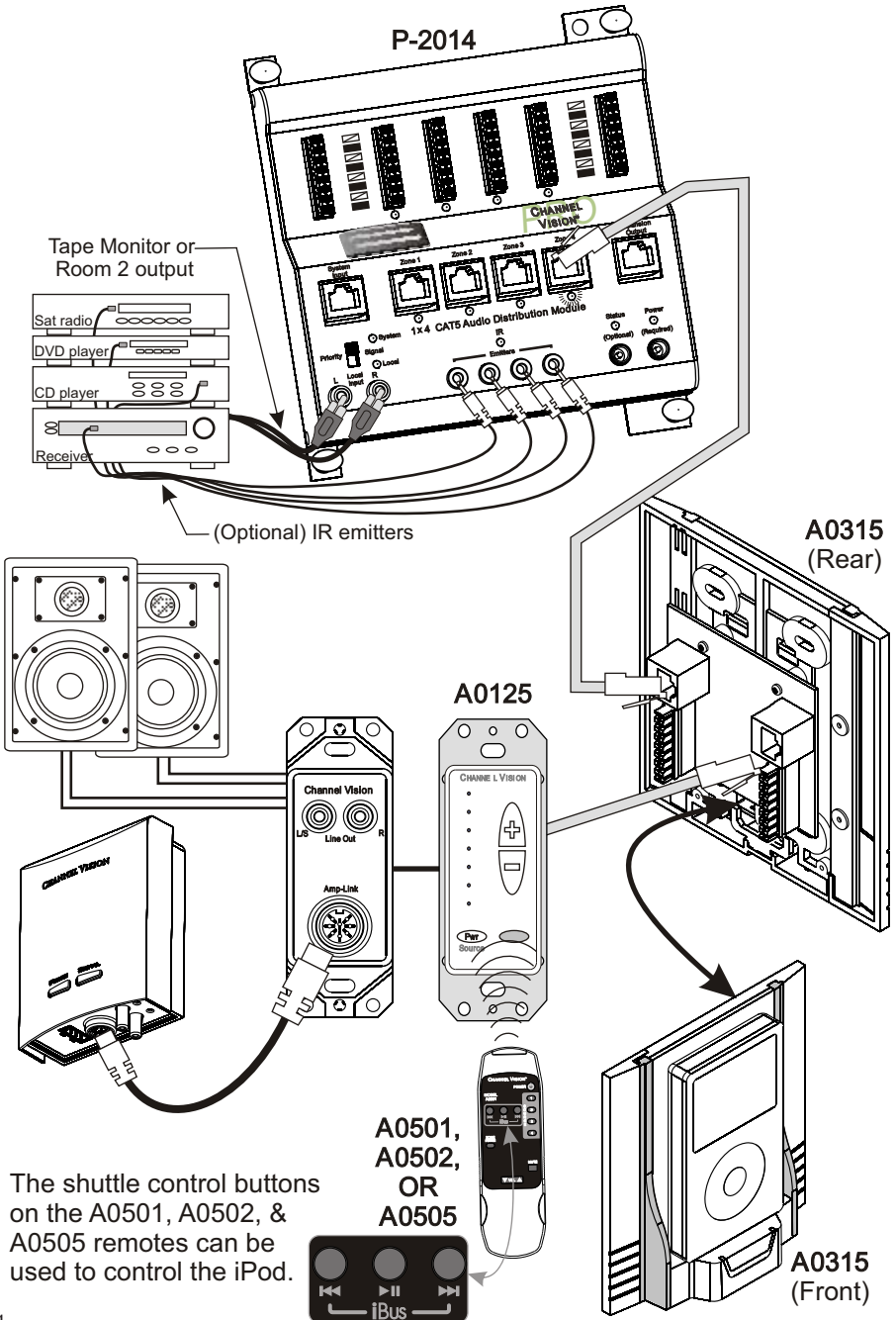

## System Wiring Diagram Using the A0315 as a main source input module

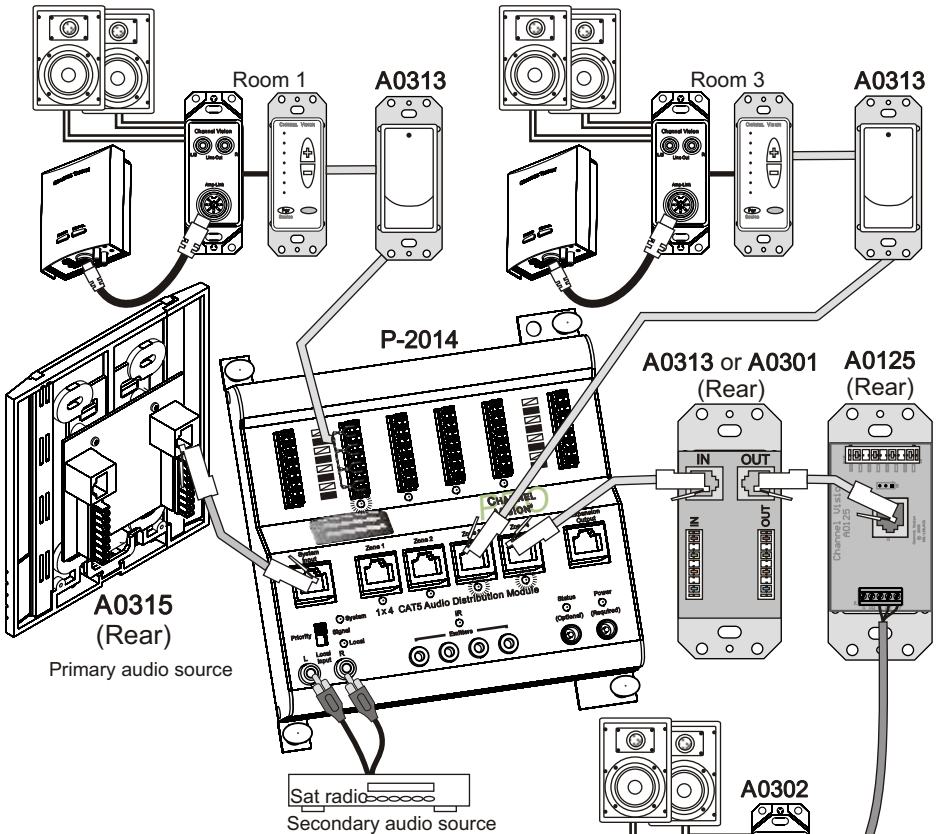

In this configuration, either the satellite radio tuner or the A0315 connected to the System Input of the P-2014 can act as the main system input. If audio is present from both sources, then the Priority switch will determine which source is heard. In this example the switch is set to give the A0313 priority.

(See A0125 manual for connection details)

A0301 and A0315 can be used as primary system inputs feeding the main hub or as local input modules in each room to override the primary audio source. The A0301 is a generic input module which provides a standard L/R RCA input and the A0315 is an iPod® docking station.

These local input modules should be installed in the CAT5 line between the P-2014 and the A0125. Multiple input modules can be installed in one CAT5 run. If audio is present at more than one input module the unit closest to A0125 will take priority and be played through the speakers.

## Installing the Wall Dock

### Installation Steps

1. Connect all wiring.
2. Attach main chassis to j-box using the provided four 6-32 screws.
3. Feed the dock connector circuit board through the opening in the front cover.
4. Hang the front cover on the main chassis from the two top tabs.
5. Secure the front cover with the two small screws at the bottom.
6. Place the dock platform over the slide rail and push downward until the retention snaps are engaged.
7. Slide the side protectors into the slots on the main chassis.

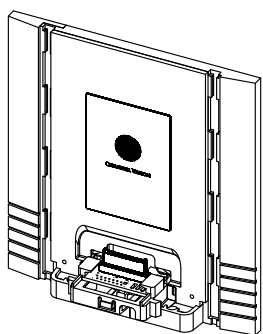
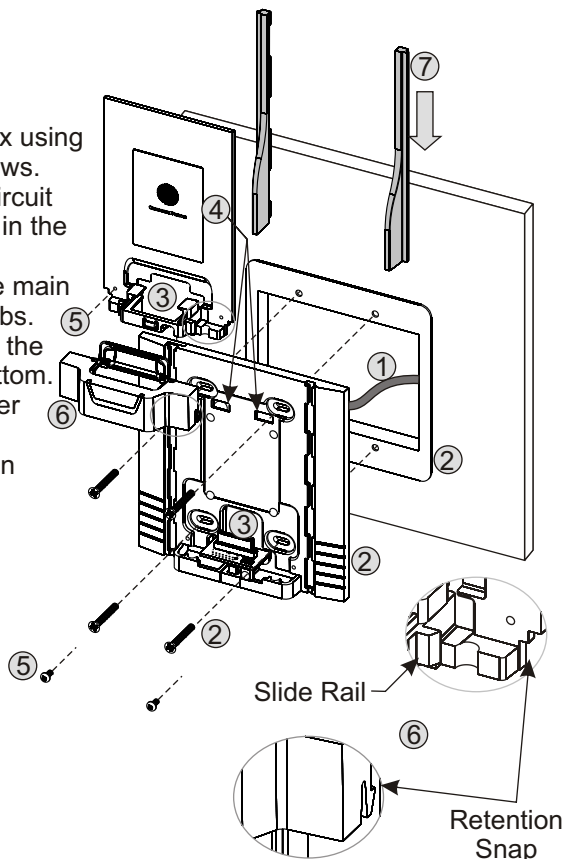

Steps 3 & 4 complete

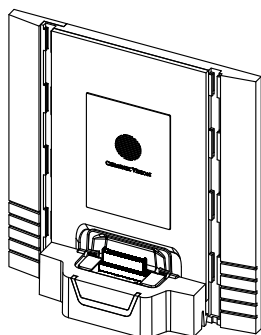

Steps 5 & 6 complete

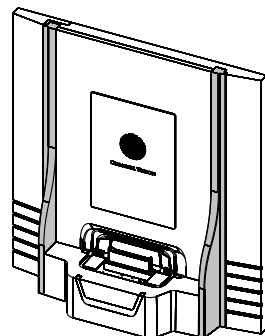

Completed Installation

## Installing the Wall Dock (3-gang Installation)

In some installations it may be desirable to mount a single gang control keypad next to the A0315. To accomplish this, the single gang trim plate can be installed next to the A0315 in a 3-gang junction box.

Follow the steps below:

### Installation Steps

1. Connect all wiring. Use the correct installation tools: J-110 tool, or 1014 crimp tool.
2. Install keypad and single-gang trim plate in the far left position of the 3-gang junction box. (See details on page 3)
3. Leave off the right side flange and trim piece.
4. Install the iPod dock in the left side of the 3-gang j-box. It will overlap and snap into the single gang trim plate. (See page 5 for details)

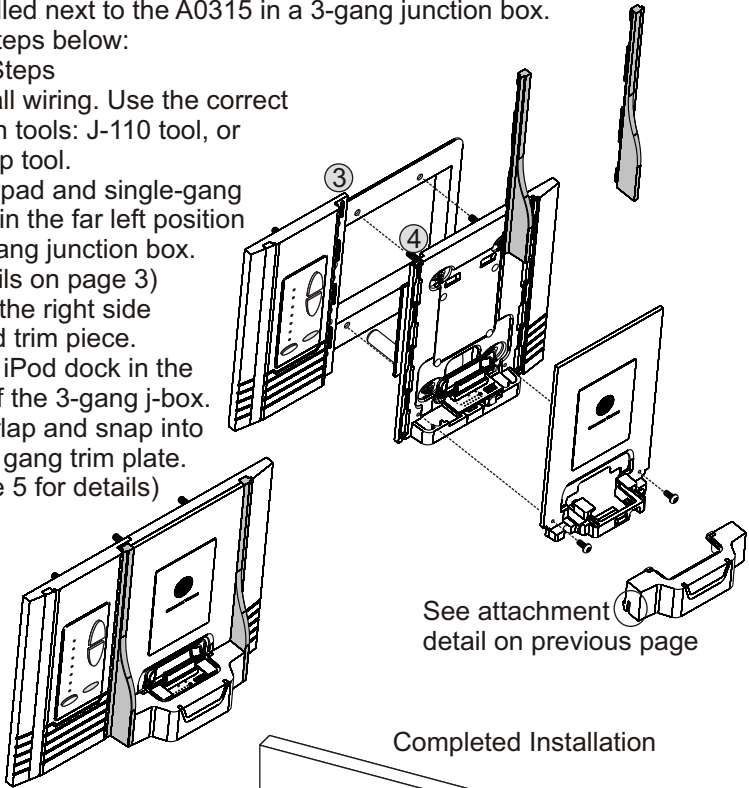

See attachment detail on previous page

### Completed Installation

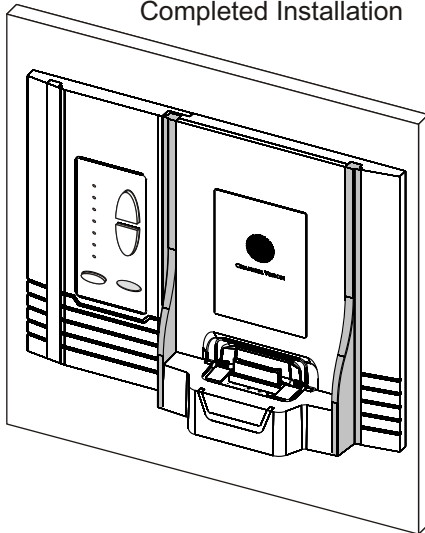

## Docking the iPod

The dock platform can slide up to hide the dock connector when the system is not in use. Make sure the dock platform is in the down position so the dock connector is exposed (as shown here).

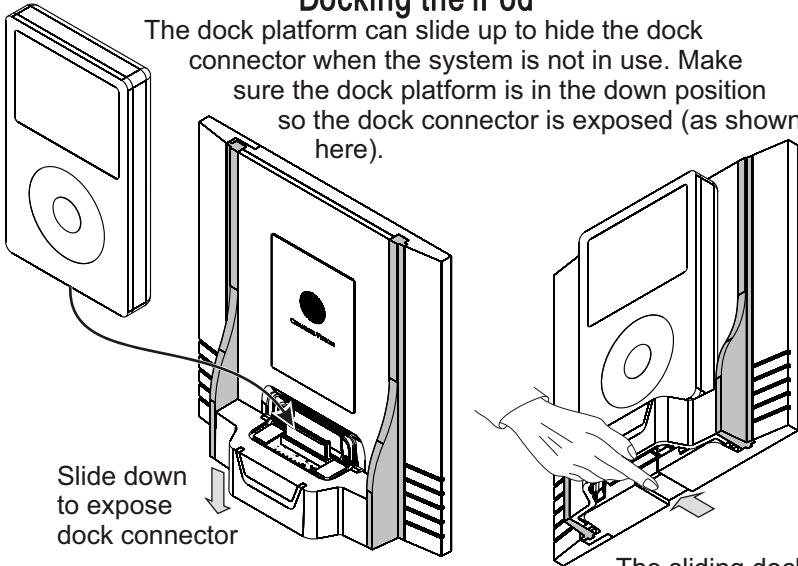

The sliding dock lever beneath the dock adjusts the position of the dock connector to create a perfect fit for all compatible iPods (see pg. 3 for compatibility).

## Using the A0505 Remote Control

The buttons above the iBus label on the A0505 remote control will mimic the functions on the iPod wheel.

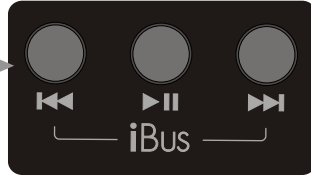

The volume, mute, power, and source buttons on the A0505 are designed to control Channel Vision's whole-house audio systems such as the A4603 and P-2044.

Please note that this remote will only function when your iPod is docked in the A0315 wall dock. It must be pointed at an IR receiver that is part of an amplified keypad that is wired "downstream".

Hex codes for IR commands:

iBus Play/Pause:

0000 006D 0000 000B 001F 001F 001F 001F 003F 003F 001F 001F 001F 001F 001F 001F 003F 001F 001F 001F 001F 003F 003F 003F 001F 0CA2

iBus Skip <<:

0000 006D 0000 000B 001F 001F 003F 001F 001F 003F 001F 001F 001F 001F 001F 001F 001F 003F 001F 001F 003F 003F 001F 0CA2

iBus Skip >>:

0000 006D 0000 000A 001F 001F 001F 001F 003F 003F 001F 001F 001F 001F 001F 001F 003F 003F 003F 001F 001F 003F 003F 001F 001F 003F 003F 0CC3



## Using the A0315 with the A0350 & A0127

The A0350 can accept the signal from one Channel Vision's CAT5 Audio Devices, such as the A0315. Audio from the iPod dock is transmitted via CAT5 into the A0350 while power is supplied from the A0350 to the iPod dock.

The power supply for the A0350 can be connected directly to the front of the A0350 or via a pair of 16AWG wires to the power screw terminals on the back side.

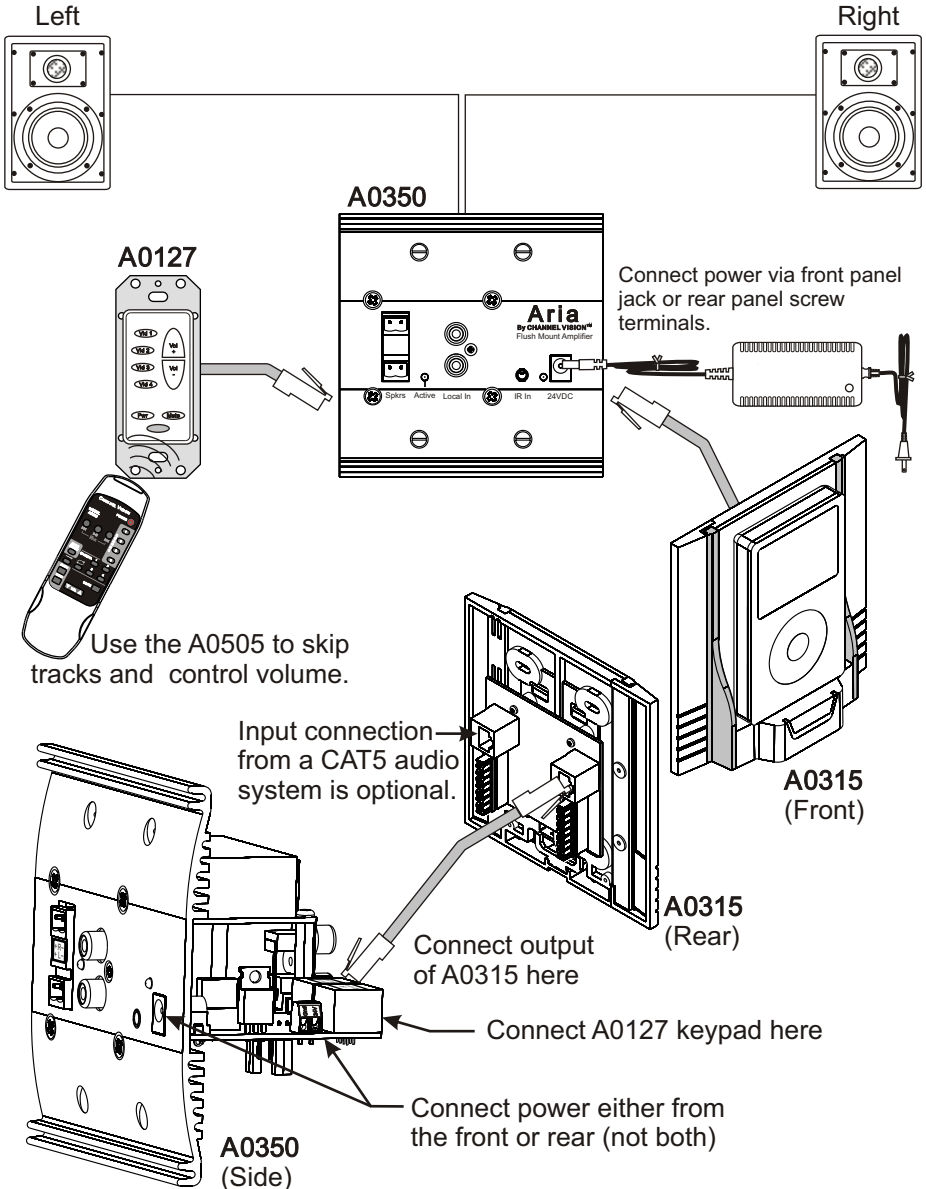

# Stripping and Connecting CAT5 Wire

CAT5 cable should be stripped with a proper stripping tool, such as Channel Vision's J-110 tool.

1. Place the CAT5 between the blade and the first notch of the J-110 tool.

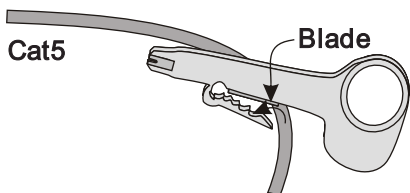

2. Rotate the tool only once. Multiple turns will cause you to cut into the inner wires.

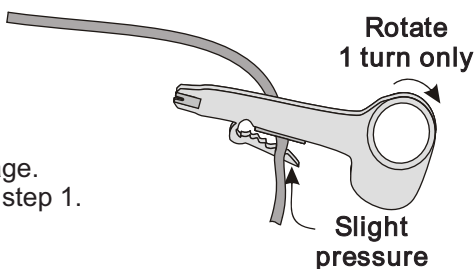

3. Inspect the inner wires for damage. If any wires are cut start over at step 1.

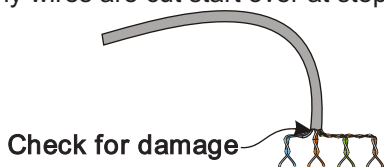

## TIA-568A RJ-45 Modular Plug

Side view:

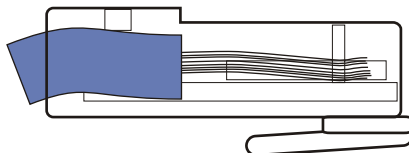

Top view:

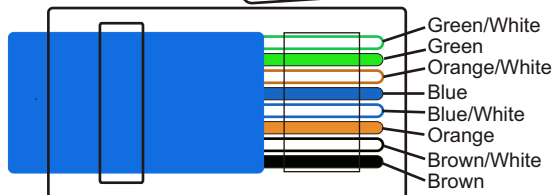

## Connection Tips and Troubleshooting

- 1) Be sure you have connected the CAT5 cable correctly. Follow the TIA-568A standard at both ends. Incorrect wiring can cause distorted sound or prevent the system from working at all!
- 2) Be sure you have connected the speakers in phase. Follow the label on the product. Out of phase speakers can rob the system of its bass. Especially when driving dual-voice-coil speakers.
- 3) Trouble with IR control?
  - a. Make sure you are using the correct remote control. The A0315 will only respond to IR signals from the Apple Remote produced by Apple Computer or the A0505 produced by Channel Vision. Other 3rd party remote controls are not supported.
  - b. Check the batteries in the remote control and change them if necessary.
- 4) The A0315 is designed to charge the iPod (*see compatibility notes on page 3*). When the iPod is not playing music, the screen should indicate that the iPod is being charged. If this does not occur, make sure the power is reaching the volume control keypad (press the volume buttons to see if the LED indicators light up).
- 5) Observe wiring distance specifications. The maximum recommended wire length between the wall dock and CAT5 audio hub is 250 feet. Although the A0315 may work at greater distances, extreme distances are not recommended because erratic performance may result due to the power loss caused by the CAT5 wire.
- 6) If you are experiencing problems with your iPod that occur even when it is not docked in the A0315, then please contact Apple customer service for support.
- 7) If you need additional help troubleshooting the A0315 please contact Channel Vision technical support or check our website for more details: [www.channelvision.com](http://www.channelvision.com).



## 1 Year Limited Warranty

Channel Vision Technology will repair or replace any defect in material or workmanship which occurs during normal use of this product with new or rebuilt parts, free of charge in the USA, for two years from the date of original purchase. This is a no hassle warranty with no mail in warranty card needed. This warranty does not cover damages in shipment, failures caused by other products not supplied by Channel Vision Technology, or failures due to accident, misuse, abuse, or alteration of the equipment. This warranty is extended only to the original purchaser, and a purchase receipt, invoice, or other proof of original purchase date will be required before warranty repairs are provided.

Mail in service can be obtained during the warranty period by calling (800) 840-0288 toll free. A Return Authorization number must be obtained in advance and can be marked on the outside of the shipping carton.

This warranty gives you specific legal rights and you may have other rights (which vary from state to state). If a problem with this product develops during or after the warranty period, please contact Channel Vision Technology, your dealer or any factory-authorized service center.

Channel Vision products are not intended for use in medical, lifesaving, life sustaining or critical environment applications. Channel Vision customers using or selling Channel Vision products for use in such applications do so at their own risk and agree to fully indemnify Channel Vision for any damages resulting from such improper use or sale.

### Specifications: (typical @25° C)

<b>Operating Voltage :</b>	18VDC
<b>Cable Requirements:</b>	CAT-5 or better
<b>Operating Temperature:</b>	-10°C to +50°C

Specifications subject to change without notice.

iPod is a trademark of Apple, Inc., registered in the U.S. and other countries.



Tested To Comply  
With FCC Standards

Model: A0315 iPod Wall Dock for Distributed Audio

This device complies with part 15 of the FCC rules. Operation is subject to the following two conditions: (1) This device may not cause harmful interference, and (2) This device must accept any interference received, including interference that may cause undesired operation.



234 Fischer Avenue, Costa Mesa, California 92626 USA  
(714)424-6500 • (800)840-0288 • (714)424-6510 fax  
email: techsupport@channelvision.com